

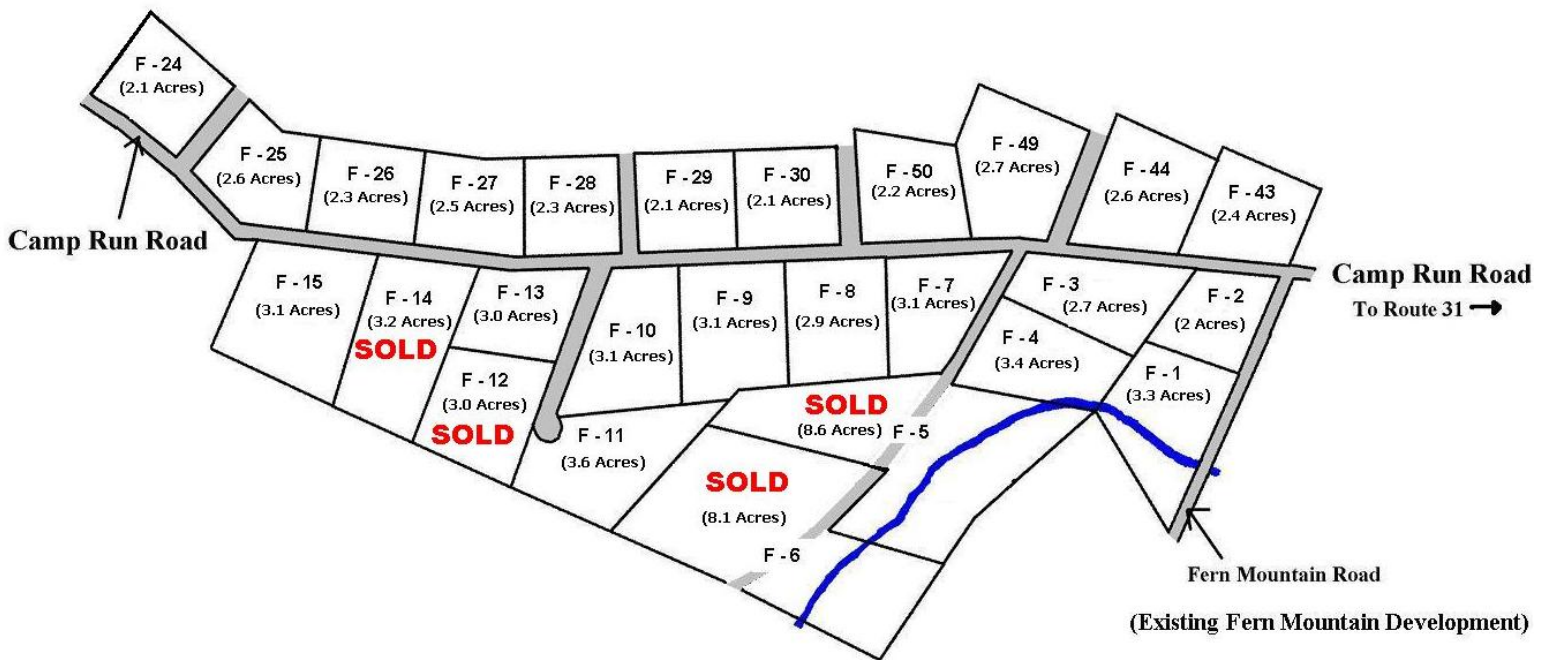

**READY FOR HOMES:**

# Fern Mountain Estates (Phase I)



Located in the heart of the Laurel Highlands  
1.1 Miles West of Hidden Valley Ski Resort on Route 31

- Most lots range from 2 to 3.6 acres
- Restrictive covenants to protect the beauty of the land and value of the property
- Fully maintained roads, through development road maintenance agreement
- All lots tested and approved for septic



*Steele Construction Inc.*

For more information, contact Bill Steele at 724-593-7203, or check out our website at [www.fernmountain.com](http://www.fernmountain.com)